

APPENDIX B

Application to vary a premises licence under the Licensing Act 2003

PLEASE READ THE FOLLOWING INSTRUCTIONS FIRST

Before completing this form please read the guidance notes at the end of the form. If you are completing this form by hand please write legibly in block capitals. In all cases ensure that your answers are inside the boxes and written in black ink. Use additional sheets if necessary.

You may wish to keep a copy of the completed form for your records.

I/We St Austell Brewery Co Ltd
(Insert name(s) of applicant)

being the premises licence holder, apply to vary a premises licence under section 34 of the Licensing Act 2003 for the premises described in Part 1 below

Premises licence number LN/000001578
--

Part 1 – Premises Details

Postal address of premises or, if none, ordnance survey map reference or description			
The Windmill Inn West Quantoxhead			
Post town	Taunton	Postcode	TA4 4DS

Telephone number at premises (if any)	N/A
Non-domestic rateable value of premises	£22,000.00 (Band B)

Part 2 – Applicant details

Daytime contact telephone number	[REDACTED]		
E-mail address (optional)	[REDACTED]		
Current postal address if different from premises address	[REDACTED]		
Post town	St Austell	Postcode	PL25 4BY

APPENDIX B

Part 3 - Variation

Please tick as appropriate

Do you want the proposed variation to have effect as soon as possible? Yes No

If not, from what date do you want the variation to take effect? DD MM YYYY

--	--	--	--	--	--	--	--

Do you want the proposed variation to have effect in relation to the introduction of the late night levy? (Please see guidance note 1) Yes No

Please describe briefly the nature of the proposed variation (Please see guidance note 2)

This is an application to vary the layout and design of the premises in accordance with the submitted plan. The changes consists of the permitting the use of an external bar at the rear of the premises (as noted on the enclosed plan). The internal licensable area of the premises is to remain unchanged from its current permission.

The locations of fire safety and other safety equipment subject to change in accordance with the requirements of the responsible authorities or following a risk assessment.

Any detail shown on the plan that is not required by the licensing plans regulations is indicative only and subject to change at any time.

Conditions proposed below to relate to the use of external area and bar only:

- The external bar servery is to operate for the sale and supply of alcohol from 11:00h until 23:00h on any day.
- The external bar will be supervised at all times when in use.
- The external bar will be inaccessible to customers when not in use to ensure they do not have access to any alcohol.

In addition, this is an application to amend the permitted hours for sale of alcohol (on and off the premises) until midnight every day (thereby removing the existing nonstandard timings which are no longer required) and to add conditions in order to update the operating schedule of the premises licence (please see part M of this application).

If your proposed variation would mean that 5,000 or more people are expected to attend the premises at any one time, please state the number expected to attend:

n/a

APPENDIX B

Part 4 Operating Schedule

Please complete those parts of the Operating Schedule below which would be subject to change if this application to vary is successful.

Provision of regulated entertainment (Please see guidance note 3)	Please tick all that apply
a) plays (if ticking yes, fill in box A)	<input type="checkbox"/>
b) films (if ticking yes, fill in box B)	<input type="checkbox"/>
c) indoor sporting events (if ticking yes, fill in box C)	<input type="checkbox"/>
d) boxing or wrestling entertainment (if ticking yes, fill in box D)	<input type="checkbox"/>
e) live music (if ticking yes, fill in box E)	<input type="checkbox"/>
f) recorded music (if ticking yes, fill in box F)	<input type="checkbox"/>
g) performances of dance (if ticking yes, fill in box G)	<input type="checkbox"/>
h) anything of a similar description to that falling within (e), (f) or (g) (if ticking yes, fill in box H)	<input type="checkbox"/>

Provision of late night refreshment (if ticking yes, fill in box I)

Supply of alcohol (if ticking yes, fill in box J)

In all cases complete boxes K, L and M

APPENDIX B

J

Supply of alcohol Standard days and timings (please read guidance note 8)			Will the supply of alcohol be for consumption – please tick (please read guidance note 9)	On the premises	<input type="checkbox"/>
Day	Start	Finish		Off the premises	<input type="checkbox"/>
				Both	<input checked="" type="checkbox"/>
Mon			State any seasonal variations for the supply of alcohol (please read guidance note 6)		
	1000	0000			
Tue					
	1000	0000	Non-standard timings. Where you intend to use the premises for the supply of alcohol at different times to those listed in the column on the left, please list (please read guidance note 7)		
Wed					
	1000	0000			
Thur					
	1000	0000			
Fri					
	1000	0000			
Sat					
	1000	0000			
Sun					
	1200	0000			

APPENDIX B

L

Hours premises are open to the public Standard days and timings (please read guidance note 8)			<u>State any seasonal variations</u> (please read guidance note 6)	
Day	Start	Finish		
Mon			As per current licence.	
Tue				
Wed				
Thur				<u>Non standard timings. Where you intend the premises to be open to the public at different times from those listed in the column on the left, please list</u> (please read guidance note 7)
Fri				
Sat				
Sun				

APPENDIX B

Please identify those conditions currently imposed on the licence which you believe could be removed as a consequence of the proposed variation you are seeking.

None.

Please tick as appropriate

- I have enclosed the premises licence
- I have enclosed the relevant part of the premises licence

If you have not ticked one of these boxes, please fill in reasons for not including the licence or part of it below

Reasons why I have not enclosed the premises licence or relevant part of premises licence.

APPENDIX B

M Describe any additional steps you intend to take to promote the four licensing objectives as a result of the proposed variation:

a) General – all four licensing objectives (b, c, d and e) (please read guidance note 11)

As per current licence (LN/000001578) save for those amendments made to the operating schedule by this application.

The locations of fire safety and other safety equipment subject to change in accordance with the requirements of the responsible authorities or following a risk assessment.

Any detail shown on the plan that is not required by the licensing plans regulations is indicative only and subject to change at any time.

Conditions proposed below to relate to the use of the external area and bar only:

- The external bar servery is to operate for the sale and supply of alcohol from 11:00h until 23:00h on any day.
- The external bar will be supervised at all times when in use.
- The external bar will be inaccessible to customers when not in use to ensure they do not have access to any alcohol.

b) The prevention of crime and disorder

An incident and refusals log ('the log') will be kept and maintained at the premises and all incidents and refusals of sales of alcohol shall be recorded in it. As a minimum, the log will record the date and time of the incident/ refusal, the name of the person making the entry, the nature of the incident/ refusal and any actions taken.

A log for all incidents is to be kept and maintained. This log must be available to Police or Council Officers on reasonable request. Relevant offences will be reported to Police in good time.

c) Public safety

Appropriate fire safety measures will be installed and maintained as shown on the drawings accompanying this application.

1. The DPS/ manager will undertake a weekly inspection of the public areas of the premises to identify anything might present an identifiable risk to public safety. Any risks identified that are deemed to be unreasonable must be rectified at the earliest possible opportunity

d) The prevention of public nuisance

A dispersal policy ('the policy') will be drawn up and implemented to ensure that as far as practicable customers leaving the premises at the end of each night's trading session do so quickly and quietly. The policy will be disseminated to staff as required to ensure that it is properly implemented and a copy kept at the premises for inspection by licensing or other responsible authority officers on reasonable request.

A sign will be displayed at each exit from the premises asking customers to respect the rights of nearby residents not to be disturbed.

APPENDIX B

e) The protection of children from harm

A Challenge 21 policy shall operate in the premises in relation to the sale of alcohol.

The only type of identification that will be accepted is a photo driving licence, passport, PASS (Proof of Age Standards Scheme) or accredited Military identification cards.

All staff shall be aware of the law regarding the refusal of service to any person who is drunk or is underage and shall be aware of how to seek ID from anyone who appears to be underage.

Checklist:

Please tick to indicate agreement

- I have made or enclosed payment of the fee; or **(paid online)**
- I have not made or enclosed payment of the fee because this application has been made in relation to the introduction of the late night levy.
- I have sent copies of this application and the plan to responsible authorities and others where applicable **(submitted online)**
- I understand that I must now advertise my application.
- I have enclosed the premises licence or relevant part of it or explanation.
- I understand that if I do not comply with the above requirements my application will be rejected.

IT IS AN OFFENCE, UNDER SECTION 158 OF THE LICENSING ACT 2003, TO MAKE A FALSE STATEMENT IN OR IN CONNECTION WITH THIS APPLICATION. THOSE WHO MAKE A FALSE STATEMENT MAY BE LIABLE ON SUMMARY CONVICTION TO A FINE OF ANY AMOUNT.

Part 5 – Signatures (please read guidance note 12)

Signature of applicant (the current premises licence holder) or applicant's solicitor or other duly authorised agent (please read guidance note 13). **If signing on behalf of the applicant, please state in what capacity.**

Signature	
Date	23 June 2021
Capacity	Solicitor and Authorised to Applicant

Where the premises licence is jointly held, signature of 2nd applicant (the current premises licence holder) or 2nd applicant's solicitor or other authorised agent (please read guidance note 14). **If signing on behalf of the applicant, please state in what capacity.**

APPENDIX B

Signature	
Date	
Capacity	

Contact name (where not previously given) and address for correspondence associated with this application (please read guidance note 15) Ellie-Nicole Davis TLT LLP One Redcliff Street			
Post town	Bristol	Post code	BS1 6TP
[REDACTED]			

Notes for Guidance

This application cannot be used to vary the licence so as to extend the period for which the licence has effect or to vary substantially the premises to which it relates. If you wish to make that type of change to the premises licence, you should make a new premises licence application under section 17 of the Licensing Act 2003.

1. You do not have to pay a fee if the only purpose of the variation for which you are applying is to avoid becoming liable for the late night levy
2. Describe the premises. For example, the type of premises, its general situation and layout and any other information which could be relevant to the licensing objectives. Where your application includes off-supplies of alcohol and you intend to provide a place of consumption of these off-supplies of alcohol, you must include a description of where the place will be and its proximity to the premises.
3. In terms of specific regulated entertainments please note that:
 - Plays: no licence is required for performances between 08.00 and 23.00 on any day, provided that the audience does not exceed 500.
 - Films: no licence is required for 'not-for-profit' film exhibition held in community premises between 08.00 and 23.00 on any day provided that the audience does not exceed 500 and the organiser (a) gets consent to the screening from a person who is responsible for the premises; and (b) ensures that each such screening abides by age classification ratings.
 - Indoor sporting events: no licence is required for performances between 08.00 and 23.00 on any day, provided that the audience does not exceed 1000.
 - Boxing or Wrestling Entertainment: no licence is required for a contest, exhibition or display of Greco-Roman wrestling, or freestyle wrestling between 08.00 and 23.00 on any day, provided that the audience does not exceed 1000. Combined fighting sports – defined as a contest, exhibition or display which combines boxing or wrestling with one or more martial arts – are licensable as a boxing or wrestling entertainment rather than an indoor sporting event.
 - Live music: no licence permission is required for:

APPENDIX B

- a performance of unamplified live music between 08.00 and 23.00 on any day, on any premises.
 - a performance of amplified live music between 08.00 and 23.00 on any day on premises authorised to sell alcohol for consumption on those premises, provided that the audience does not exceed 500.
 - a performance of amplified live music between 08.00 and 23.00 on any day, in a workplace that is not licensed to sell alcohol on those premises, provided that the audience does not exceed 500.
 - a performance of amplified live music between 08.00 and 23.00 on any day, in a church hall, village hall, community hall, or other similar community premises, that is not licensed by a premises licence to sell alcohol, provided that (a) the audience does not exceed 500, and (b) the organiser gets consent for the performance from a person who is responsible for the premises.
 - a performance of amplified live music between 08.00 and 23.00 on any day, at the non-residential premises of (i) a local authority, or (ii) a school, or (iii) a hospital, provided that (a) the audience does not exceed 500, and (b) the organiser gets consent for the performance on the relevant premises from: (i) the local authority concerned, or (ii) the school or (iii) the health care provider for the hospital.
 - Recorded Music: no licence permission is required for:
 - any playing of recorded music between 08.00 and 23.00 on any day on premises authorised to sell alcohol for consumption on those premises, provided that the audience does not exceed 500.
 - any playing of recorded music between 08.00 and 23.00 on any day, in a church hall, village hall, community hall, or other similar community premises, that is not licensed by a premises licence to sell alcohol, provided that (a) the audience does not exceed 500, and (b) the organiser gets consent for the performance from a person who is responsible for the premises.
 - any playing of recorded music between 08.00 and 23.00 on any day, at the non-residential premises of (i) a local authority, or (ii) a school, or (iii) a hospital, provided that (a) the audience does not exceed 500, and (b) the organiser gets consent for the performance on the relevant premises from: (i) the local authority concerned, or (ii) the school proprietor or (iii) the health care provider for the hospital.
 - Dance: no licence is required for performances between 08.00 and 23.00 on any day, provided that the audience does not exceed 500. However, a performance which amounts to adult entertainment remains licensable.
 - Cross activity exemptions: no licence is required between 08.00 and 23.00 on any day, with no limit on audience size for:
 - any entertainment taking place on the premises of the local authority where the entertainment is provided by or on behalf of the local authority;
 - any entertainment taking place on the hospital premises of the health care provider where the entertainment is provided by or on behalf of the health care provider;
 - any entertainment taking place on the premises of the school where the entertainment is provided by or on behalf of the school proprietor; and
 - any entertainment (excluding films and a boxing or wrestling entertainment) taking place at a travelling circus, provided that (a) it takes place within a moveable structure that accommodates the audience, and (b) that the travelling circus has not been located on the same site for more than 28 consecutive days.
4. Where taking place in a building or other structure please tick as appropriate (indoors may include a tent).

APPENDIX B

5. For example state type of activity to be authorised, if not already stated, and give relevant further details, for example (but not exclusively) whether or not music will be amplified or unamplified.
6. For example (but not exclusively), where the activity will occur on additional days during the summer months.
7. For example (but not exclusively), where you wish the activity to go on longer on a particular day e.g. Christmas Eve.
8. Please give timings in 24 hour clock (e.g. 16.00) and only give details for the days of the week when you intend the premises to be used for the activity.
9. If you wish people to be able to consume alcohol on the premises, please tick 'on the premises'. If you wish people to be able to purchase alcohol to consume away from the premises, please tick 'off the premises'. If you wish people to be able to do both, please tick 'both'.
10. Please give information about anything intended to occur at the premises or ancillary to the use of the premises which may give rise to concern in respect of children regardless of whether you intend children to have access to the premises, for example (but not exclusively) nudity or semi-nudity, films for restricted age groups or the presence of gaming machines.
11. Please list here steps you will take to promote all four licensing objectives together.
12. The application form must be signed.
13. An applicant's agent (for example solicitor) may sign the form on their behalf provided that they have actual authority to do so.
14. Where there is more than one applicant, each of the applicants or their respective agents must sign the application form.
15. This is the address which we shall use to correspond with you about this application.

APPENDIX B

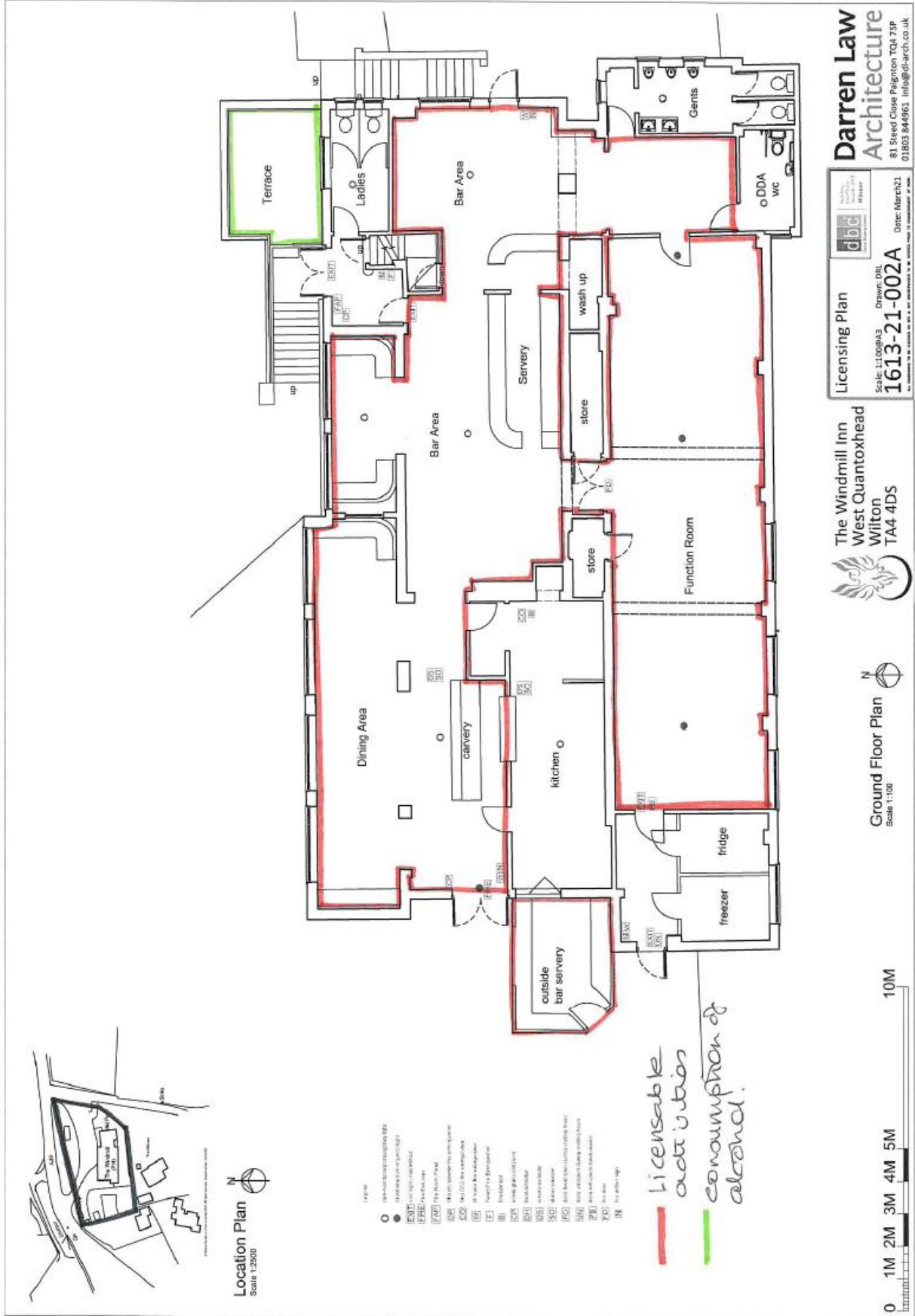

APPENDIX B

